

TECHNICAL INFORMATION SHEET

No. 0705-01
15-May-07

rheavendors 
servomat UK

Brewer Service Procedure

Applies to all rheavendors Presso Bean Machines

Parts Required

Item	Qty.	Large brewer (Orange brew chamber)	Standard Brewer (black brew chamber)
Upper Piston O-Ring	1	GUA0000097	GUA0000080
Filter Plate	2	0250008211	0250008019
Lower O-ring	1	GUA0000065	GUA0000065
Items below are optional (replace only if required)			
Inlet pipe Assy.	1	0250008110CL	0250008110CL
Outlet pipe Assy.	1	0250008076CL	0250008070CL

Procedure

- 1) Remove brewer front cover. Give the brewer a thorough rinse, the brewer can be completely submerge and rinse under a tap, the brewer should be cycled manually whilst rinsing.
- 3) Remove upper piston: Undo and remove screws and adjusting plates from both sides of the brewer (Fig. 1 & 2). Inspect the positions of the adjusting plates for reassembly, make a note of the letter lined up on the plate and the body. Undo and remove screw A (Fig. 1)

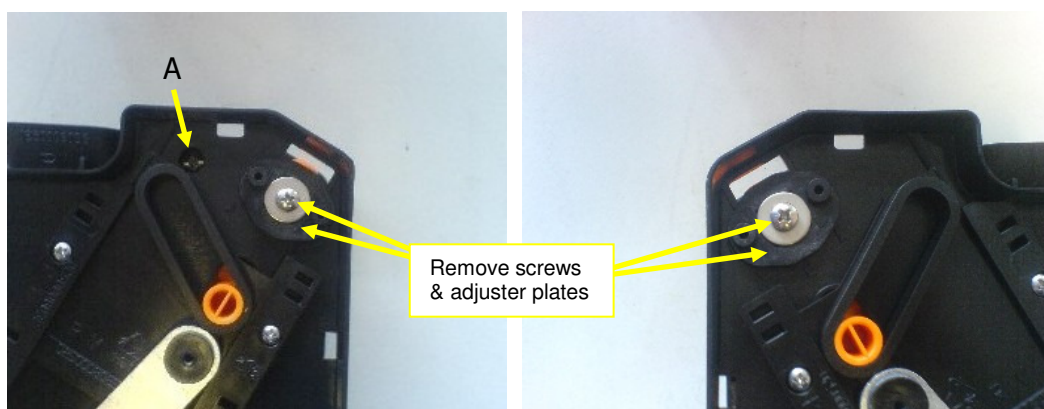

Fig. 1

Fig. 2

- 4) Gently pull brewer halves apart at the top to release the upper piston (Fig. 3) remove O-ring (A) and filter plate by removing screw (B).

Clean the area under the filter plate thoroughly using a suitable brush and water. Ensure that the water outlet channel is clear. Clean the o-ring groove.

Refit new o-ring and new filter plate.

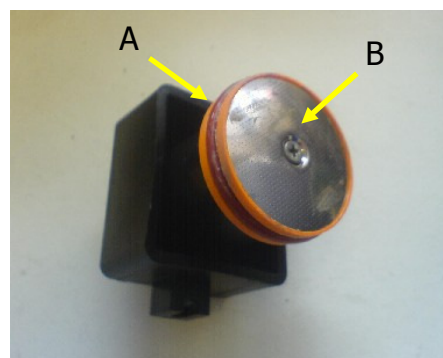

Fig. 3

rheavendors servomat UK
3 Charlwood Court, County Oak Way, Crawley, West Sussex, RH11 7XA
Telephone: 01293 553332 Fax: 01293 536738 e-mail: info@rheavendors-servomat.co.uk

TECHNICAL INFORMATION SHEET

No. 0705-01
15-May-07

rheavendors 
servomat UK

- 5) Remove screws and plastic guide washers from both sides of the brewer (Fig. 4)
- 6) Squeeze brew chamber guides to release from the slots either side of the brewer. Rotate the brew chamber into the position shown (Fig. 5)

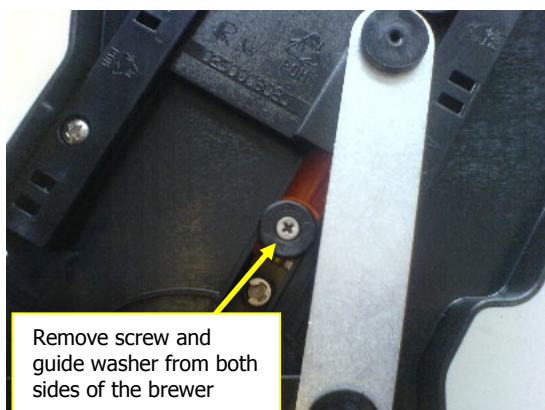

Fig. 4

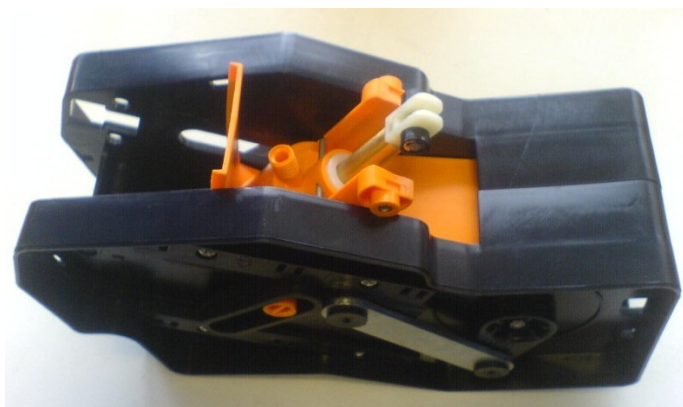

Fig. 5

- 7) Remove the lower piston roll support, (Fig. 6). Push the lower piston out of the brew chamber.
- 8) Remove the filter plate by undoing screw A (Fig. 7). Thoroughly clean the area beneath the filter plate with a suitable brush and water. Thoroughly clean the brass piston rod. Refit a new filter plate.



Fig. 6

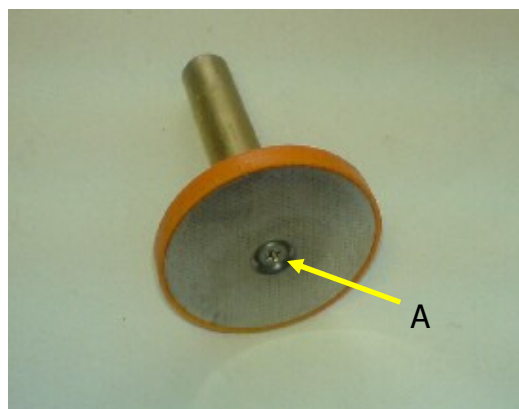

Fig. 7

- 9) Clean the inside of the brew chamber ensure the water inlet to the brew chamber is clear. Inspect the chamber for any damage or deep scratches in the chamber sides. Any deep scratches will prevent a tight seal when the chamber is closed and could result in a leak. If the brew chamber is damaged it should be replaced.

TECHNICAL INFORMATION SHEET

No. 0705-01
15-May-07

- 10) Remove the securing pins and remove the piston guide (Fig. 8) replace the lower piston O-ring (Fig. 9)

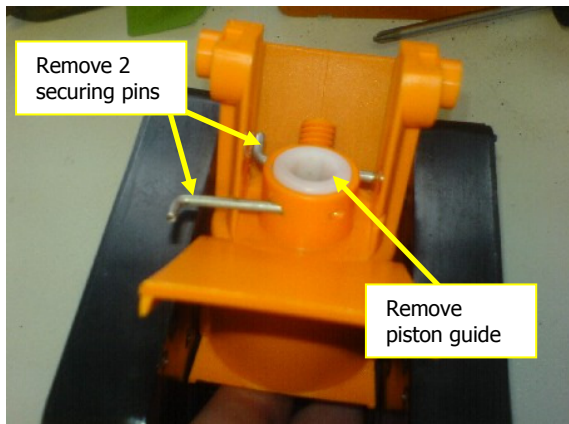

Fig. 8

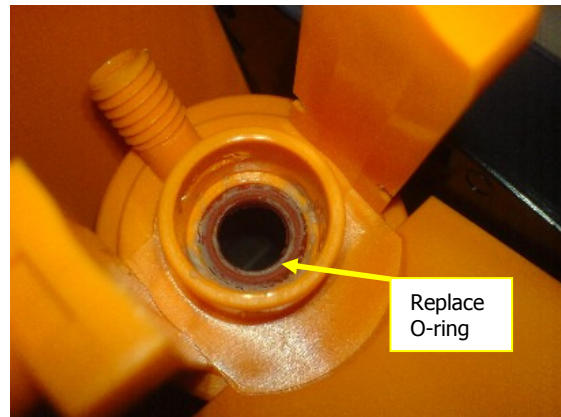

Fig. 9

- 11) Inspect the inlet and outlet pipes for damage or blockage, replace or clean as required.
- 12) Reassemble the brewer in the reverse order.
- Grease the O-rings, brass rod, and internal surface of the brew chamber with a suitable food safe lubricant.
 - Take care that the roll support removed in step 7 is replaced securely and is lined up with the driving cam (the correct orientation of the roller is shown in Fig. 5).
 - Ensure that the upper piston adjusting guides are replaced in the correct positions.
- 12) Before fitting the brewer in a machine ensure that at least 1 full cycle can be made manually to make sure that the brewer has been assembled correctly.
- 13) Test the brewer in a machine, ensure that there are no leaks and that the brewer cycles completely.

GMS Services
Unit K2 Rose Business Park
Marlow Bottom Road
Marlow
Bucks
SL7 3ND