

TECHNICAL INFORMATION SHEET

No. 0910-01
12-Oct-2009

rheavendors 
servomat UK

Fitting instructions Coin Acceptor KIT G-13 MFT in XS GRANDE SM / PB:

The Set includes:

- 1 Coin Acceptor NRI G13 MFT
- 1 Coin Acceptor mounting plate
- 1 Front plate
- 1 Lockable Coin Box
- 1 Ribbon Cable 10 way
- 6 Screws (4 X 3.5 x 9.5 mm)
- (2 X 3.5 x 16 mm)

1. Locate the coin acceptor blanking plate on the right side of the door.
2. To release push the blanking plate from inside to outside.
3. Remove the blanking plate.

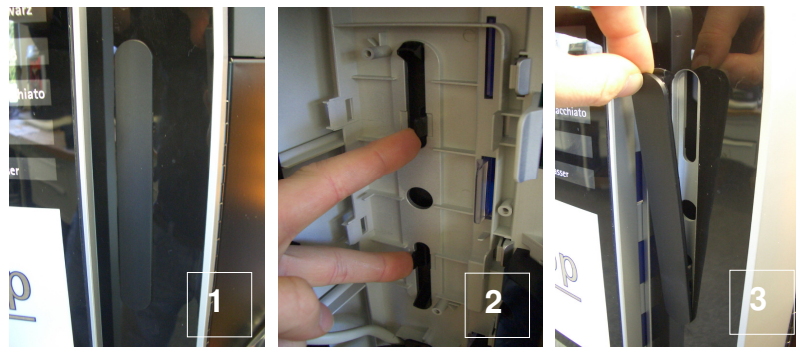

4. Locate the holes for the securing screws.
5. Place the acceptor mounting plate over the holes as in fig. 5
6. Fit the front plate as in fig. 6 and secure to the mounting plate with 2 screws (3.5 x 16 mm) top and bottom.

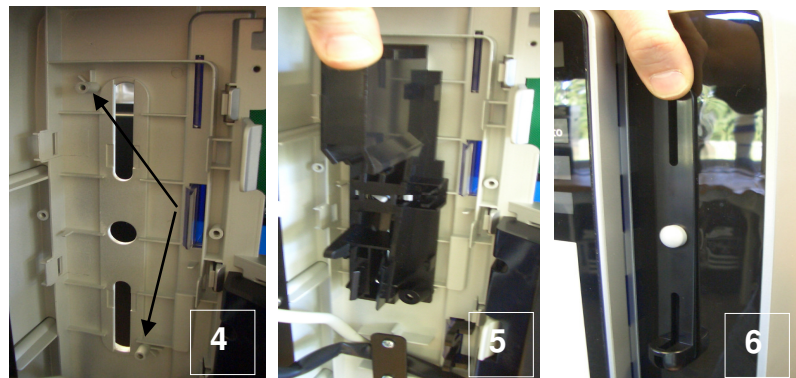

7. Secure the mounting plate to the door with 2 screws (3.5 x 9.5 mm)
8. Fit the coin acceptor to the mounting plate.
9. Remove the orange cover inside the door.

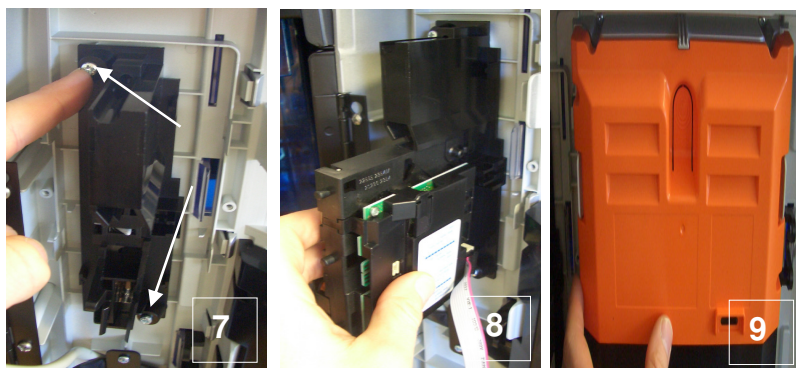

rheavendors servomat UK
3 Charlwood Court, County Oak Way, Crawley, West Sussex, RH11 7XA
Telephone: 01293 553332 Fax: 01293 536738 e-mail: info@rheavendors-servomat.co.uk

TECHNICAL INFORMATION SHEET

No. 0910-01
12-Oct-2009

rheavendors 
servomat UK

- 10. Attach one end of the 10-way ribbon cable to the board (connector J4).
- 11. Attach the other end of the 10-way ribbon cable to the connector on the left side of the coin acceptor.



- 12. Replace the orange cover.
- 13. Remove the cable retaining plate below the fitted coin acceptor.
- 14. Fit the coin box bracket in this place instead.

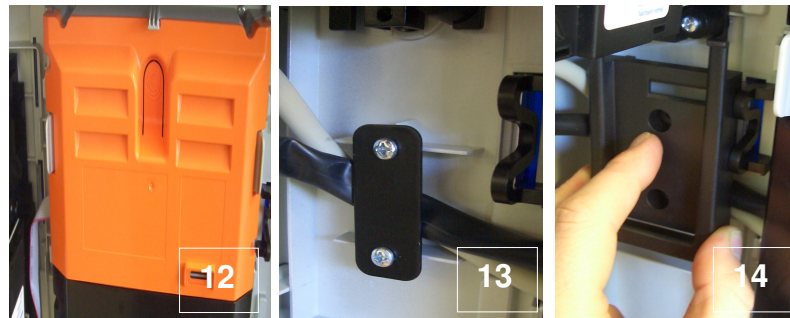

- 15. Here you see the bracket in place.
- 16. Hang the cash box on the bracket.
- 17. Click the splash cover for the coin acceptor on and supplied with the included (3.5 x 9.5 mm).

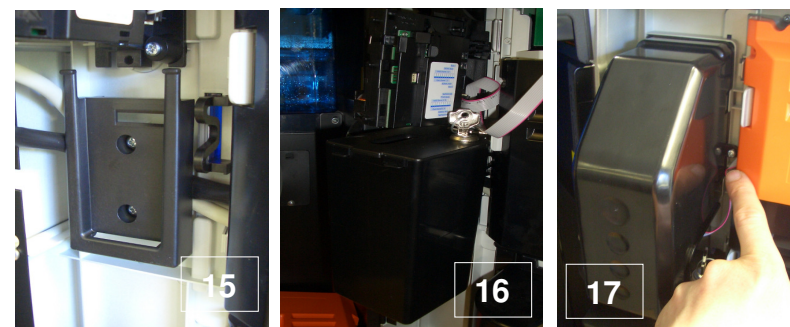

Test the Coin acceptance!

