

MINI MAGNUM INSTRUCTIONS

Open Door

**Press Flush Audit Program (Red Button) 4 times
Display will now say**

SET TEMPERATURE

PROGRAM DRINKS

LOAD DEFAULTS

Press program. Display will show all available options

Press the drink you wish to program i.e. white coffee

The display will high light the following:-

COFFEE

WHITENER

WATER

The coffee light will be flashing

Use UP/DOWN buttons to increase or decrease coffee

Repeat for whitener and water

**The gram throw and water volume will be shown bottom right on
the display**

Move to next drink and repeat sequence

When finished either press EXIT or TEST DRINK

The ACTIVE button will always be the only button flashing

OUTPUT PCB

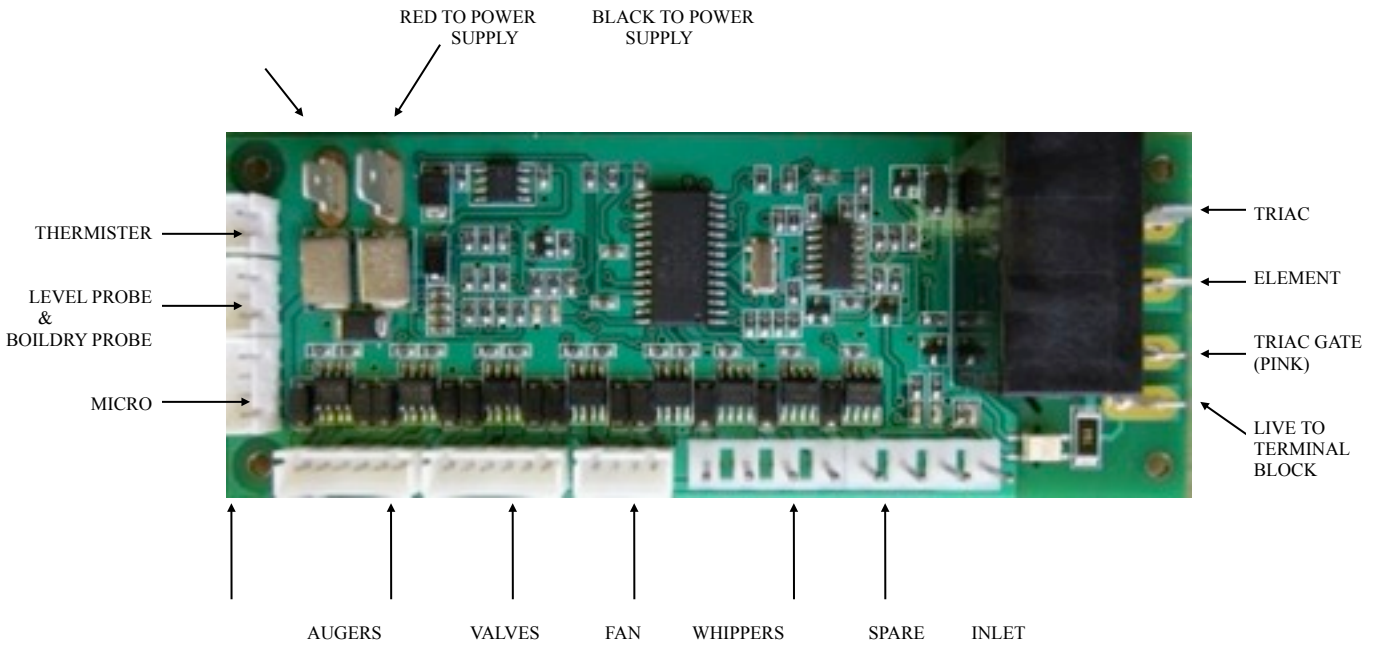

100-12 SWITCHING POWER SUPPLY

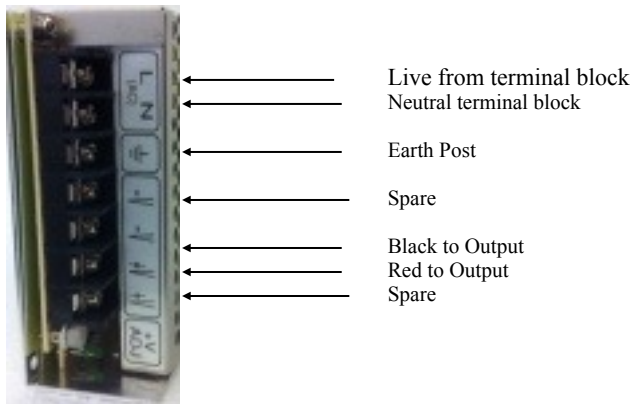

WHIPPER BOWL ASSEMBLY

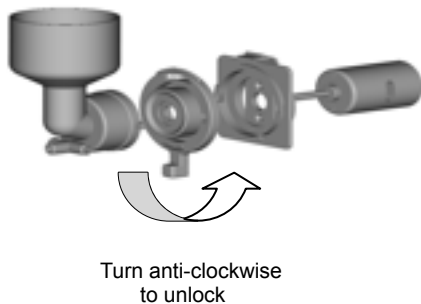

The whipping assembly on this machine is of an improved type, a diagram of which is shown above. The system provides both an improved drink quality and a better construction method to allow for easier maintenance and cleaning.

Hygiene is an important part of the operation of the machine, all ingredient / water contact parts should be cleaned regularly and if components are in a poor condition, they should be replaced immediately.

ERROR CODES

Fault codes are shown on the display by the word 'Fault codes' followed by a 2 digit number.

Once a fault code is shown, the machine will no longer function until it is turned off and back on again.

Error No. Meaning

| | |
|--|---------------------------------|
| 01 Power board failure | |
| 02 | Thermistor open circuit |
| 03 Thermistor short circuit | |
| 04 Overfill probe | |
| 05 Boil dry active | |
| 06 Scale build up | |
| 07 The element has failed | |
| 08..10 | Reserved |
| 11 The Cappuccino button is stuck in | |
| 12 The Café Latte button is stuck in | |
| 13 The White coffee button is stuck in | |
| 14 The Black coffee button is stuck in | |
| 15 | The Espresso button is stuck in |
| 16 The Mocha button is stuck in | |
| 17 The Chocomilk button is stuck in | |
| 18 The Chocolate button is stuck in | |
| 19 The Hot water button is stuck in | |
| 20 The Top-Up button is stuck in | |
| 21 The Large button is stuck in | |
| 22 The Strong button is stuck in | |
| 22..29 | Unused |
| 30 The program button is stuck in | |

ELECTRONICS

| ITEM | PART NO. | DESCRIPTION |
|-------------------------------|-----------------|--|
| 1 | K03-005 | OUTPUT PCB |
| 2 | K03-001 | LCD DISPLAY PCB |
| 3 | K03-004 | SWITCHING POWER SUPPLY |
| 4 | K01-412 | TRIAC 3KW |
| 5 | R01-025/1 | TERMINAL BLOCK |
| 6 | K01-407 | PROGRAM PUSH BUTTON |
| 7 | K03-002 | CUP STATION LIGHT |
| 8 | K03-003 | CUP STATION LIGHT LENS |
| WATER & DISPENSING | | |
| 9 | T01-403 | BOILER ASSEMBLY LESS VALVES (ITEMS 10-19) |
| 10 | T01-401 | BOILER BODY |
| 11 | T01-402 | BOILER TOP |
| 12 | A01-012 | BOILER GASKET |
| 13 | H01-001 | ELEMENT 3KW |
| 14 | T02-003 | ELEMENT WASHER x 2 |
| 15 | S01-005/1 | LEVEL PROBE |
| 16 | S01-003/1 | OVERFLOW PROBE |
| 17 | K02-013 | THERMISTER |
| 18 | B04-001 | VALVE BOOT |
| 19 | B04-005 | DISPENSE VALVE 12v |
| 20 | A01-001 | INLET VALVE |
| 21 | W01-012 | PUMP 12v |
| 22 | W01-002 | WATER CARRIER 10LTR |
| 23 | O01-003 | AUGER MOTOR 12v |
| 24 | O01-003/1 | AUGER DRIVE PINION |
| 25 | B01-020 | CANNISTER WITH WHEEL |
| 26 | B01-021 | CANNISTER NO WHEEL |
| 27 | B01-015 | CANNISTER CHOCOLATE WITH WHEEL |
| 28 | B01-008 | ELBOW STRAIGHT (COFFEE) |
| 29 | B01-018 | ELBOW L/H (MILK) |
| 30 | B01-019 | ELBOW R/H (CHOCOLATE) |
| 31 | B01-037 | CANNISTER DRIVE |
| 32 | B01-038 | CANNISTER AUGER |
| 33 | B01-012 | CANNISTER WHEEL (MILK) |
| 34 | B01-042 | CANNISTER WHEEL (CHOCOLATE) |
| 35 | B01-005 | WHIPPER STEAM TRAP SEAL |
| 36 | B01-004 | WHIPPER STEAM TRAP |
| 37 | B01-006 | WHIPPER BOWL ADAPTOR |
| 38 | B01-026 | WHIPPER MIXING BOWL |
| 39 | B01-025 | WHIPPER IMPELLOR BLADE |
| 40 | B01-024 | WHIPPER BASE & SEAL |
| 41 | B01-007/2 | WHIPPER SHAFT SEAL |
| 42 | B01-007/3 | WHIPPER BASE O-RING |
| 43 | B01-028 | WHIPPER PIPETTE |
| 44 | B01-022 | WHIPPER SLINGER WASHER |
| 45 | B01-023 | WHIPPER MOTOR 12V |
| 46 | B01-029 | WHIPPER MOUNTING |
| 47 | T02-002 | SILICON TUBE (Per Metre) |
| 48 | E01-001 | DISPENSE NOZZLE |
| 49 | G01-001 | ELBOW (BREATHER) |
| AIR EXTRACTION | | |
| 50 | J01-018 | EXTRACTION DUCT |
| 51 | R01-002 | EXTRACTION HOSE |
| 52 | B03-001 | FAN 12v |
| 53 | J01-001 | FAN BOX |
| CABLES | | |
| 54 | A01-003 | MAINS CABLE WITH PLUG |

| | | |
|----------------|---------|---------------------------------|
| 55 | K03-012 | LOOM SET |
| 56 | K02-016 | MICRO LEAD (Door to back board) |
| 57 | H02-006 | STRAIN RELIEF BUSH |
| CHASSIS | | |
| 58 | T03-004 | CHASSIS COMPLETE |
| 59 | J03-005 | DOOR |
| 60 | J02-002 | FRONT BASE |
| 61 | J01-017 | DRIP TRAY (incl grill) |
| 62 | T01-119 | LOCK & KEYS Incl cam |
| 63 | T01-120 | KEYS 92276 (Per pair) |
| 64 | R01-026 | FEET (Each) |
| 65 | L03-016 | SIDE OVALS (PER PR) |
| 66 | D03-006 | LEFT SIDE BUTTONS |
| 67 | D03-007 | RIGHT SIDE BUTTONS |
| 68 | D03-008 | TOP/BOTTOM BUTTONS |