

Monarch/Sovereign

INSTRUCTIONS

1. Open Door
2. Press Flush Audit Program 4 times
3. The display will now say ADJUST DRINKS
4. On the outside keypad on the front press centre button
5. The display will now say SET WHICH DRINK
6. Press the drink you wish to set i.e. White Coffee
7. The display will now say COFFEE and a figure in grams i.e. COFFEE 2.8g
8. Adjust this setting ether with the Coffee Black button to increase the strength or the Espresso button to decrease the strength
9. To test your drink press the centre button. This will give you a test drink while in program mode
10. Now press the Cafe Latte to move onto the next setting i.e. to adjust the whitener
11. The display will now say WHITENER and a figure in grams i.e. WHITENER 6.0g
12. Adjust this setting ether with the Coffee Black to increase the strength or the Espresso to decrease the strength
13. To test you drink press the centre button. This will give you a test drink while in program mode
14. Now press the Café Latte button to move onto the next setting i.e. to adjust the water
15. The display will now say VOL and a figure in ml i.e. VOL 150.0ml
16. Adjust this setting ether with the Coffee Black button to increase the strength or the Espresso button to decrease the strength
17. To test your drink press the centre button. This will give you a test drink while in program mode
18. When you are happy with the setting & adjustments you have made press the Mocha button
19. The display will now say ADJUST DRINKS
20. Repeat the procedure from section 4 to adjust the next drink i.e. cappuccino
21. When you are happy with all your settings & adjustments press the Mocha button
22. The display will now say ADJUST DRINKS
23. Press the Mocha button once more
24. The display will now say MAKE SELECTION
25. The machine will now be ready to use

The buttons will illuminate if they are appropriate to the programming mode
If a drink is to be selected, all buttons will illuminate
The buttons should be used in conjunction with the messages on the display

Whipper Bowl Assembly

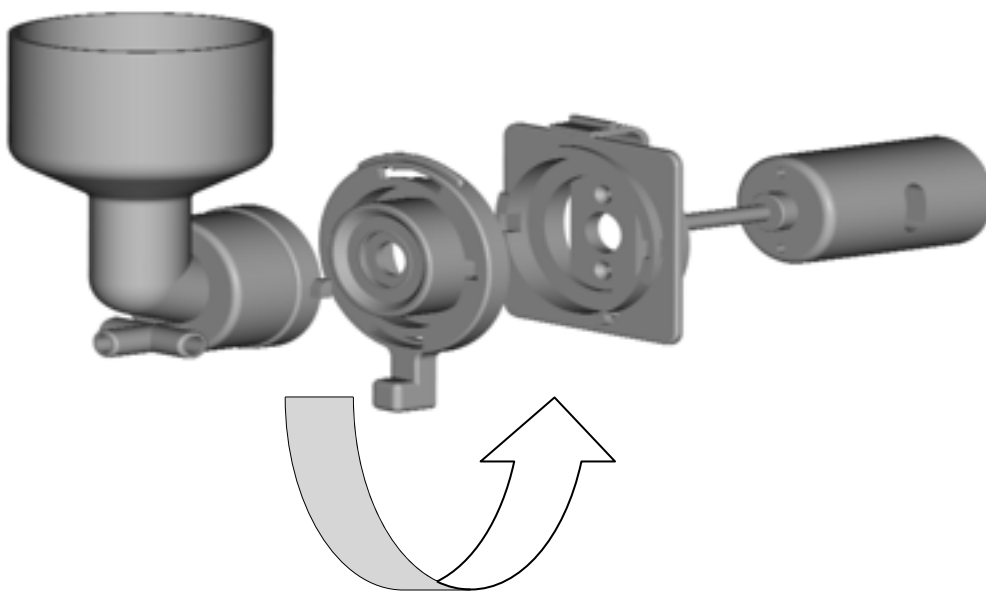

Turn anti-clockwise
to unlock

The whipping assembly on this machine is of an improved type, a diagram of which is shown above. The system provides both an improved drink quality and a better construction method to allow for easier maintenance and cleaning.

Hygiene is an important part of the operation of the machine, all ingredient / water contact parts should be cleaned regularly and if components are in a poor condition, they should be replaced immediately.

MONARCH & SOVEREIGN PARTS LIST

ELECTRONICS

ITEM	PART NO.	DESCRIPTION
1	K02-001	OUTPUT PCB
2	K02-002	BUTTON PCB - (MONARCH)
3	K02-004	BUTTON PCB - (SOVEREIGN)
4	K02-003	DISPLAY PCB
5	K01-411	PSU PCB
6	K02-011	BOIL DRY PCB
7	K02-012	BACK LIGHT UNIT
8	K01-406	TRANFORMER 100VA
9	K01-020	FUSE 3-15A
10	K01-412	TRIAC 3KW
11	R01-025/1	TERMINAL BLOCK
12	K01-407	PROGRAM PUSH BUTTON
13	D01-003	BUTTON PAD (9) (MONARCH)
14	D01-004	BUTTON PAD (11) (SOVEREIGN)

WATER & DISPENSING

15	T01-403	BOILER ASSEMBLY LESS VALVES (ITEMS 16-24)
16	T01-401	BOILER BODY
17	T01-402	BOILER TOP
18	A01-012	BOILER GASKET
19	H01-001	ELEMENT 3KW
20	T02-003	ELEMENT WASHER x 2
21	S01-005/1	LEVEL PROBE
22	S01-003/1	OVERFLOW PROBE
23	K02-013	THERMISTER
24	B04-001	VALVE BOOT
25	B04-005	DISPENSE VALVE 12v
26	H01-003	THERMAL CUT OUT
27	A01-001	INLET VALVE
28	W01-012	PUMP 12v
29	W01-002	WATER CARRIER 10LTR
30	O01-003	AUGER MOTOR 12v
31	O01-003/1	AUGER DRIVE PINION
32	B01-020	CANNISTER MONARCH WITH WHEEL
33	B01-021	CANNISTER MONARCH NO WHEEL
34	B01-034	CANNISTER SOVEREIGN WITH WHEEL
35	B01-035	CANNISTER SOVEREIGN NO WHEEL
36	B01-008	ELBOW MONARCH STRAIGHT (COFFEE)
37	B01-018	ELBOW MONARCH L/H (MILK)
38	B01-019	ELBOW MONARCH R/H (CHOCOLATE)
39	B01-039	ELBOW SOVEREIGN STRAIGHT (COFFEE)
40	B01-040	ELBOW SOVEREIGN L/H (MILK)
41	B01-041	ELBOW SOVEREIGN R/H (CHOCOLATE)

