

XPRESSION MINI 3

INSTRUCTIONS

1. Open Door
2. Press red button 4 times
3. The display will now say ADJUST DRINKS
4. On the outside keypad on the front door press the tick button
5. The display will now say SET WHICH DRINK
6. Press the drink you wish to set i.e. White Coffee
7. The display will now say COFFEE and a figure in grams i.e. COFFEE 2.8g
8. Adjust this setting either with the up arrow to increase the strength or the down arrow to decrease the strength
9. To test you drink press the cross button. This will give you a test drink while in program mode
10. Now press the arrow that points to the right to move onto the next setting i.e. to adjust the whitener
11. The display will now say WHITENER and a figure in grams i.e. WHITENER 6.0g
12. Adjust this setting either with the up arrow to increase the strength or the down arrow to decrease the strength
13. To test you drink press the cross button. This will give you a test drink while in program mode
14. Now press the arrow that points to the right to move onto the next setting i.e. to adjust the water
15. The display will now say VOL and a figure in ml i.e. VOL 150.0ml
16. Adjust this setting either with the up arrow to increase the strength or the down arrow to decrease the strength
17. To test you drink press the cross button. This will give you a test drink while in program mode
18. When you are happy with the setting & adjustments you have made press the button marked exit
19. The display will now say ADJUST DRINKS
20. Repeat the procedure from section 4 to adjust the next drink i.e. cappuccino
21. When you are happy with all your settings & adjustments press the exit button
22. The display will now say ADJUST DRINKS
23. Press the exit button once more
24. The display will now say MAKE SELECTION
25. The machine will now be ready to use

Whipper Bowl Assembly

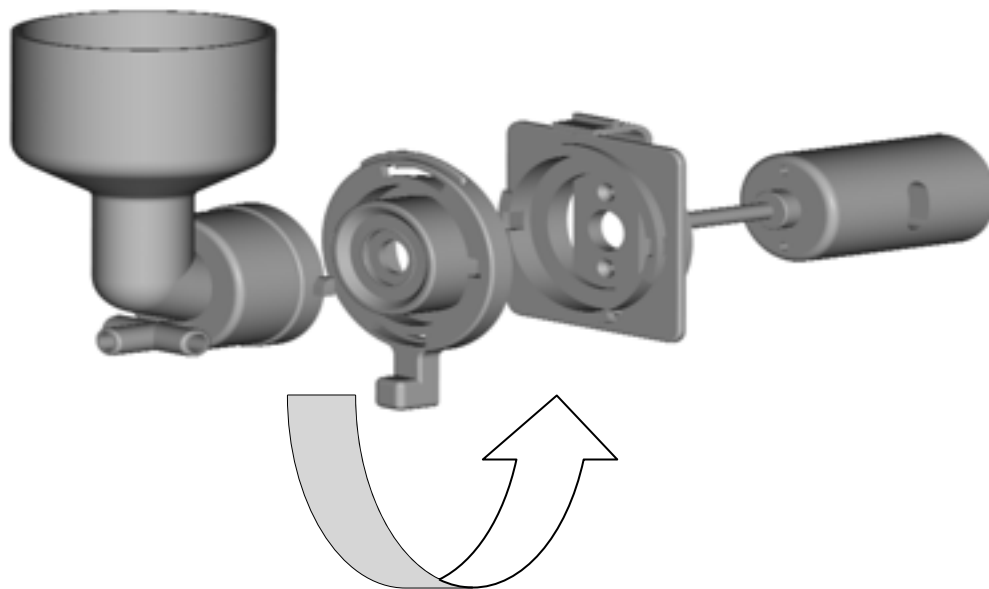

Turn anti-clockwise
to unlock

The whipping assembly on this machine is of an improved type, a diagram of which is shown above. The system provides both an improved drink quality and a better construction method to allow for easier maintenance and cleaning.

Hygiene is an important part of the operation of the machine, all ingredient / water contact parts should be cleaned regularly and if components are in a poor condition, they should be replaced immediately.

ITEM	PART NUMBER	DESCRIPTION
1	K01-417	OUTPUT PCB
2	K01-411	PSU PCB
3	K01-421	HARNESS COMPLETE
4	K01-422	MICRO LEAD
5	K01-412	TRIAC 3KW
6	K01-410	TRANSFORMER 150VA
7	K01-419	BUTTON PCB - XPRESSION 4 & 5
8	K01-420	BUTTON PCB - XPRESSION 3
9	K01-418	DISPLAY
10	K01-013	PROGRAM SWITCH
11	K01-018	KEY SWITCH (COIN ONLY)
12		
13		
14	T03-003	BOILER ASSY (ITEMS 16-27 INCL.)
15	T03-001	BOILER BODY
16	T03-002	BOILER LID
17	T02-009	GASKET
18	R01-012	M4 FULL NUT S/STEEL
19	S01-001	PROBE HOLDER
20	S01-003	PROBE OVERFLOW
21	S01-005	PROBE LEVEL
22	K01-014	THERMISTER
23	K01-015	METAL SET PUTTY 10mm
24	H01-001	ELEMENT 3KW
25	T02-003	ELEMENT WASHER
26	H01-002	ELEMENT 4.8KW
27	M01-001	DISPENSE VALVE 12V
28	B04-001	VALVE BOOT GROMMET TYPE
29	B04-002	VALVE BOOT GROMMET TYPE BLIND
30	A01-001	12V INLET VALVE
31	T02-002	SILICON TUBE (P. METRE)
32		
33	B01-026	MIXING BOWL
34	B01-025	IMPELLOR
35	B01-027	STEAM TRAP
36	B01-005	STEAM TRAP SEAL
37	B01-006	BOWL ADAPTOR
38	B01-024	WHIPPER BASE WITH SEAL
39	B01-007/1	SHAFT SEAL
40	B01-008	CANISTER ELBOW
41	S01-004	NOZZLE BLOCK
42	E01-001	DISPENSE NOZZLE

	PART NUMBER	DESCRIPTION
43		
44		
45		
46		
47		
48	B01-023	WHIPPER MOTOR 12V
49	B01-015	CANISTER SINGLE WITH WHEEL
50	B01-016	CANISTER SINGLE NO WHEEL
51	B01-012	CANISTER WHEEL
52	B01-017	CANISTER DOUBLE SIZE
53		
54		
55	O01-003	AUGER MOTOR 12V 80
56	R01-009	SELF TAP AUGER SCREWS
57		
58		
59		
60	B03-001	FAN 12V
61	J01-001	FAN BOX
62	R01-002	EXTRACTION TUBE
63	J01-004	AIR EXTRACTION DUCT- XPRESSION 3
64	J01-007	AIR EXTRACTION DUCT- XPRESSION 5
65	R01-001	CABLE GLAND
66	A01-003	MAINS LEAD & PLUG
67	R01-025	TERMINAL BLOCK
68	R01-022	GROMMET 20mm OPEN
69	H02-002	P. CLIP
70		
71		
72	K01-422	PLASTIC FRONT XPRESSION 3 FREEVEND
73	K01-423	PLASTIC FRONT XPRESSION 3 COIN
74	K01-424	PLASTIC FRONT XPRESSION 5 FREEVEND
75	K01-425	PLASTIC FRONT XPRESSION 5 COIN
76		
77		
78	J01-009	DRIP TRAY
79	P01-002	6" GRILL
80	J01-011	CUP STAND WITH 4" GRILL
81	T02-203	CUP GUIDE
82		
83	M02-001	COIN MECH
84		